



201 Douglas & 421/461 Plaza Drive, Dunedin, Florida, 34698

Suburban style three building office park.
 Located a minutes walk from Historic Downtown Dunedin.

BUILDING SPECIFICATIONS

Property ID	18161021
Property Type	Office
Lease/For Sale	Lease

PROPERTY HIGHLIGHTS

- Upscale, suburban style office park
- Suites Available:
 - 1,020 SF
 - 1,020 SF
 - 2,050 SF
 - 2,569 SF
- \$17.50/SF Modified Gross
- Close proximity to restaurants, Dunedin Harbor, Dunedin Causeway, and John R. Lawrence Pioneer Park.

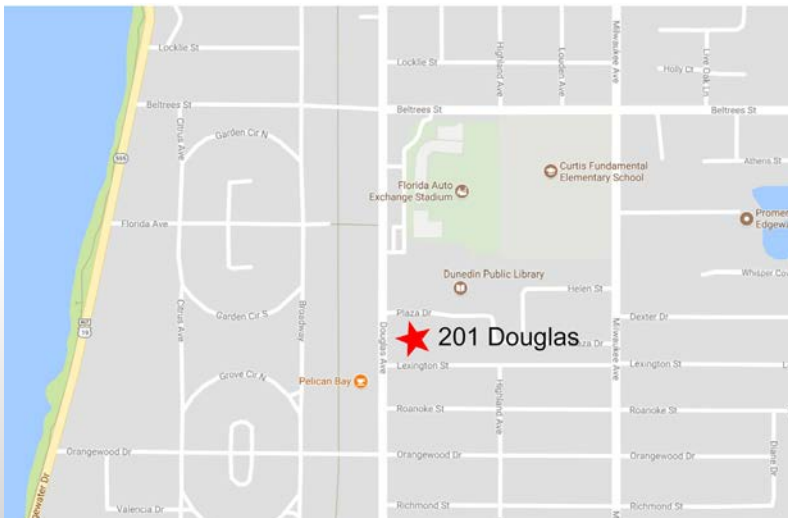

FOR LEASING & MANAGEMENT

Frank Cisneros | fcisneros@thekraussorg.com
 Office: (813) 885-5656
 Cell: (813) 220-5566

NOTICE TO BROKERS AND PROSPECTIVE PURCHASERS/TENANTS: THE MATERIAL CONTAINED IN THIS OFFERING IS FURNISHED SOLELY FOR THE PURPOSE OF YOUR CONSIDERATION TO PURCHASE/LEASE THE PROPERTY CONTAINED HEREIN, AND IS NOT TO BE USED FOR ANY OTHER PURPOSE WITHOUT THE EXPRESS WRITTEN CONSENT OF THE KRAUSS ORGANIZATION OR THE OWNER. THE MATERIAL IS BASED ON INFORMATION OBTAINED BY OWNER AND ON INFORMATION OBTAINED BY THE KRAUSS ORGANIZATION FROM SOURCES THEY DEEM RELIABLE. THIS IS A SUMMARY OF PERTINENT FACTS ON THE PROPERTY AND IS NOT INTENDED TO CONTAIN ALL OF THE INFORMATION DESIRED BY A PROSPECTIVE PURCHASER/TENANT. PROSPECTIVE PURCHASERS/TENANTS SHOULD MAKE THEIR OWN INVESTIGATION AND CONCLUSIONS WITHOUT RELIANCE UPON THE MATERIAL CONTAINED HEREIN. NEITHER OWNER NOR THE KRAUSS ORGANIZATION, NOR ANY OF THEIR OFFICERS, EMPLOYEES OR AGENTS MAKE ANY REPRESENTATION OR WARRANTY EXPRESSED OR IMPLIED AS TO THE ACCURACY OR COMPLETENESS OF THIS OFFERING.

SITE & FLOORPLAN

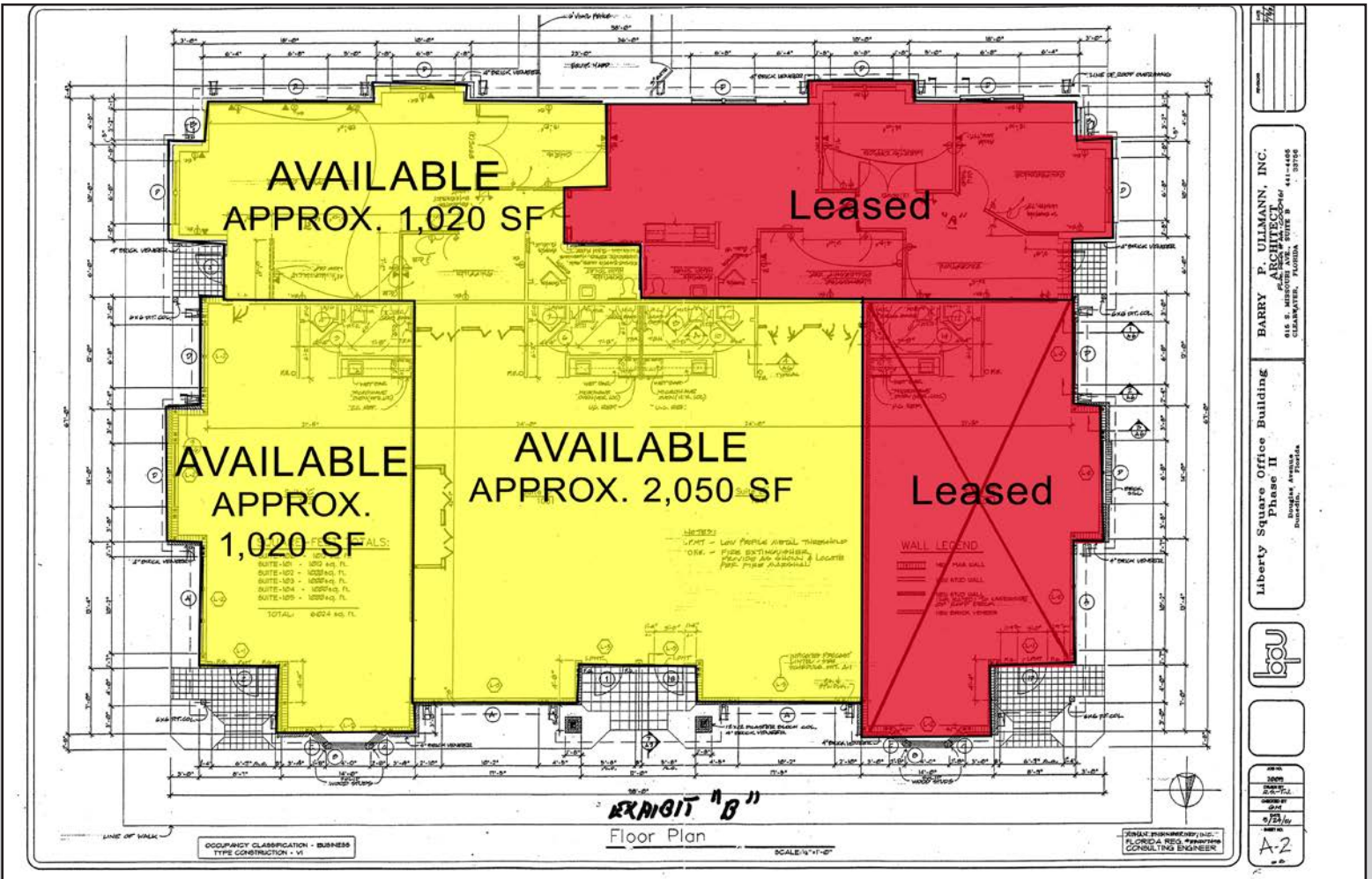

SITE & FLOORPLAN

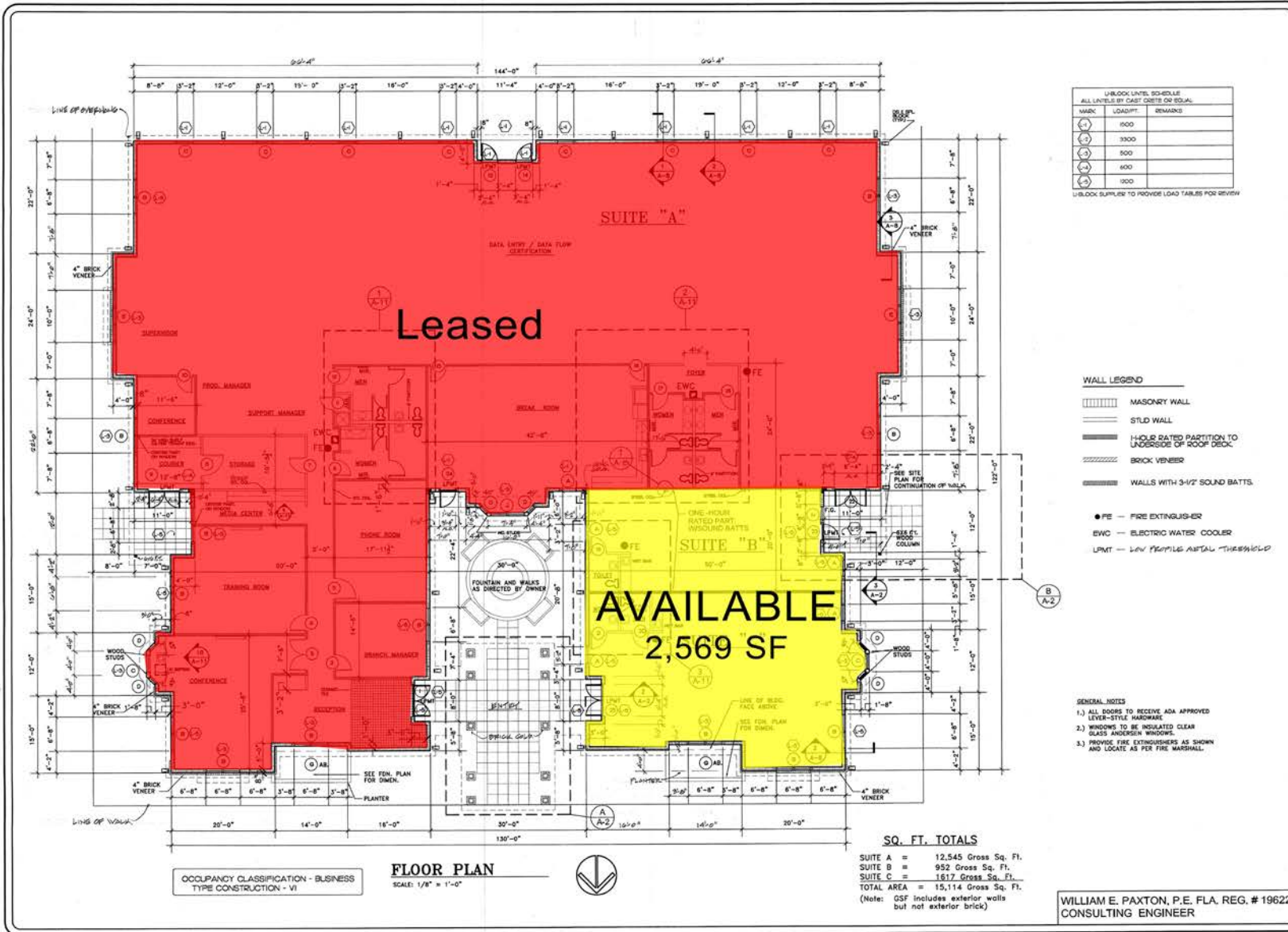

UNBLOCK LEVEL SCHEDULE
ALL LEVELS BY CAST CONCRETE ON EQUAL

MARK	LOAD/FT ²	REMARKS
1	1500	
2	3300	
3	500	
4	600	
5	300	

UNBLOCK SUPPLIER TO PROVIDE LOAD TABLES FOR REVIEW

- WALL LEGEND**
- MASONRY WALL
 - STUD WALL
 - 1-HOUR RATED PARTITION TO UNDERSIDE OF ROOF DECK
 - BRICK VENEER
 -
- FE — FIRE EXTINGUISHER
 EWC — ELECTRIC WATER COOLER
 LPM — LOW PROFILE METAL THRESHOLD

- GENERAL NOTES**
- 1.) ALL DOORS TO RECEIVE ADA APPROVED LEVER-STYLE HANDWARE
 - 2.) WINDOWS TO BE INSULATED CLEAR GLASS ANDERSEN WINDOWS.
 - 3.) PROVIDE FIRE EXTINGUISHERS AS SHOWN AND LOCATE AS PER FIRE MARSHAL.

DATE	
REVISION	

BARRY P. ULLMANN, INC.
ARCHITECT
 815 S. MISSOURI AVE., SUITE B
 CLEARWATER, FLORIDA 34615

LIBERTY SQUARE OFFICE BUILDING
 DOUGLAS AVENUE
 DUNEDIN, FLORIDA



DATE	
REVISION	

WILLIAM E. PAXTON, P.E. FLA. REG. # 19622
CONSULTING ENGINEER

A-3
 OFP 12